

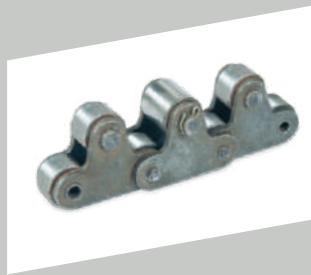

# Chains and Sprockets for Palm Oil Mill

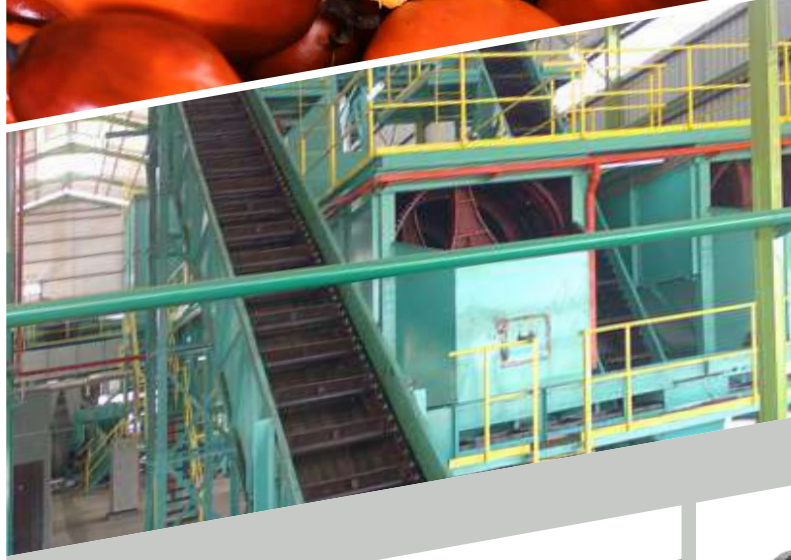

We help the world move



**ROLcon**  
ENGINEERING CO. LTD.

## High Performance Hollow Pin/Solid Pin Type Chains

High Performance Conveyor chains are designed and manufactured for the generation industrial use. Standard type chains are normally in stock to ensure prompt delivery. Special type chains are also available upon request.

The solid pin type of chain, is applicable to the same wheels as Equivalent hollow pin type of chain but the breaking load of the chain is higher than that of the equivalent hollow pin type of chain, and is particularly preferred for conveyors working under severe loading.

### HOLLOW BEARING PIN TYPE ROLLER CHAIN

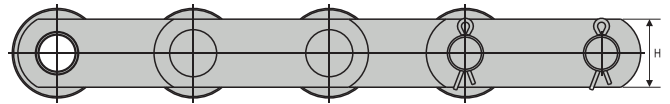
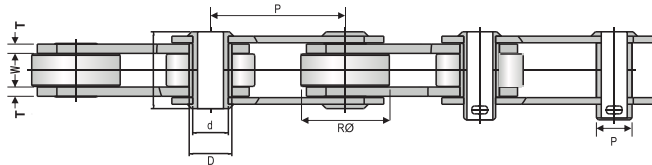

All Dimensions in MM

ROL-KOBO NO.	PITCH		BREAKING LOAD		ROLLER DIA	H.PIN DIA	HOLLOW PIN I.D	LINK	LINK IL	INSIDE WIDTH	LINK OL
	INCH	MM	LBS	KGS	RØ	D	d	H	T	I.W	T
H060 030	3"	76.2	6000	2727	31.75	13.97	9.65	25.4	4.32	15.24	3.81
H060 040	4"	101.6	6000	2727	31.75	13.97	9.65	25.4	4.32	15.24	3.81
H060 060	6"	152.4	6000	2727	31.75	13.97	9.65	25.4	4.32	15.24	3.81
H120 030	3"	76.2	12000	5455	47.5	19.05	13.21	38.1	5.08	19.05	3.81
H120 040	4"	101.6	12000	5455	47.5	19.05	13.21	38.1	5.08	19.05	3.81
H120 060	6"	152.4	12000	5455	47.5	19.05	13.21	38.1	5.08	19.05	3.81
H240 040	4"	101.6	24000	10909	66.8	26.92	19.56	50.8	7.1	25.4	5.1
H240 060	6"	152.4	24000	10909	66.8	26.92	19.56	50.8	7.1	25.4	5.1

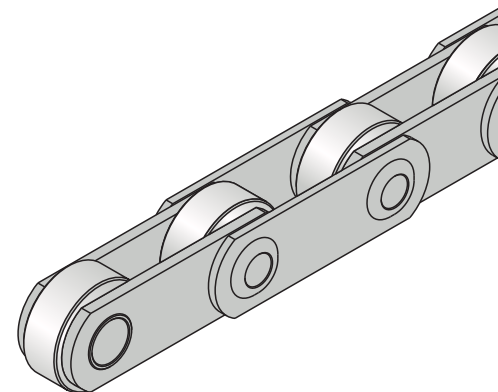

### SOLID BEARING PIN TYPE ROLLER CHAIN

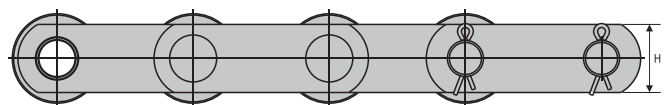
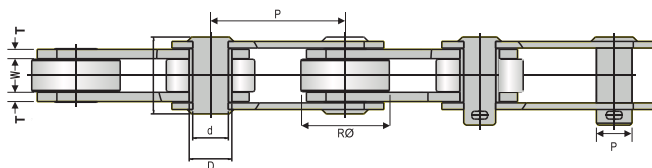

All Dimensions in MM

ROL-KOBO NO.	PITCH		BREAKING LOAD		ROLLER DIA	H.PIN DIA	HOLLOW PIN I.D	LINK	LINK IL	INSIDE WIDTH	LINK OL
	INCH	MM	LBS	KGS	RØ	D	d	H	T	I.W	T
S060 030	3"	76.2	7500	3409	31.75	13.97	9.65	25.4	4.32	15.24	3.81
S060 040	4"	101.6	7500	3409	31.75	13.97	9.65	25.4	4.32	15.24	3.81
S060 060	6"	152.4	7500	3409	31.75	13.97	9.65	25.4	4.32	15.24	3.81
S120 030	3"	76.2	15000	6818	47.5	19.05	13.21	38.1	5.08	19.05	3.81
S120 040	4"	101.6	15000	6818	47.5	19.05	13.21	38.1	5.08	19.05	3.81
S120 060	6"	152.4	15000	6818	47.5	19.05	13.21	38.1	5.08	19.05	3.81
S240 040	4"	101.6	30000	13636	66.8	26.92	19.56	50.8	7.1	25.4	5.1
S300 060	6"	152.4	30000	13636	66.8	26.92	19.56	50.8	7.1	25.4	5.1

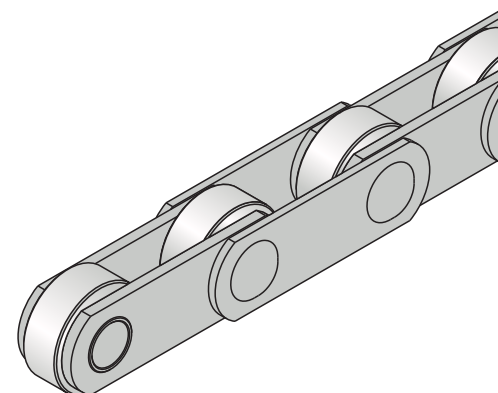

## HIGH PERFORMANCE SOLID BEARING PIN TYPE CONVEYOR CHAIN

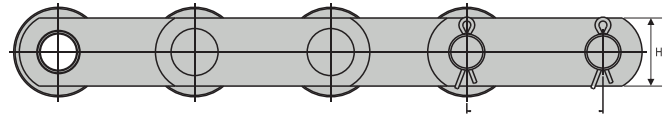
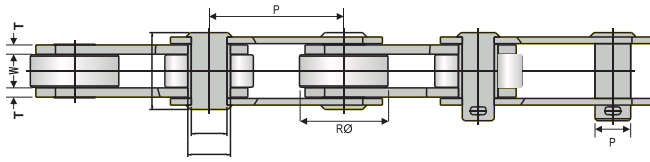

All Dimensions in MM

SR. NO.	ROL-KOBU NO.	PITCH		BREAKING LOAD		ROLLER DIA MM	PIN DIA MM	LINK H (MM)	LINK T (MM)	INSIDE WIDTH MM
		INCH	MM	LBS	KGS					
1	3821/A	6"	152.4	18000	8182	47.6	14.56	40	5	19
2	3822/A	6"	152.4	60000	27273	66.7	19	50	10	25.4
3	3966/A	6"	152.4	26000	11818	57	14.5	45	6	25.4
4	4315	4"	101.6	26000	11818	47.6	16	40	5	19
5	3966	6"	152.4	26000	11818	55	HOLLOW PIN 22Ø X13.2Ø	45	6	22
6	4539	6"	152.4	30000	13636	63.5	15.85	50	7	25.4
7	3823	6"	152.4	50000	22727	66.7	19	50	8	25.4
8	4560	4"	101.6	26000	11818	BUSH DIA 20.10	12.7	40	5	19
9	4314	6"	152.4	50000	22727	66.7	HOLLOW PIN 27.5Ø X 20.1Ø	50	8	26
10	4522	4"	101.6	30000	13636	63.5	15.85	50	7	25.4
11	4478/A	4"	101.6	30000	13636	63.5	15.85	50	7	25.4
12	3820	4"	101.6	15000	6818	32	19.05	40	5	19
13	4540/A	4"	101.6	15000	6818	50.8	19.05	40	5	19

## High Performance Chains and Sprockets



## SOLID PIN CONVEYOR CHAIN

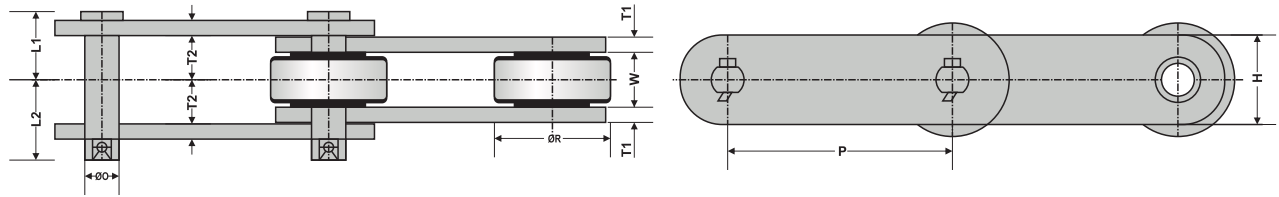

All Dimensions in MM

ROL-KOBO No.	Pitch P	Inner Width W	Roller Diameter R	Pin Diameter D	L1	L2	Plate Height H	Inner Plate Thickness T1	Outer Plate Thickness T2	Average Tensile Strength (kgf)
RKPO - 101	76.70	30.00	29.00	14.50	33.00	36.00	38.10	6.30	6.30	11,500
RKPO - 102	101.60	21.40	47.60	11.32	28.50	28.50	31.80	4.80	4.80	9,300
RKPO - 103	101.60	30.00	50.80	14.50	36.00	36.00	38.10	6.30	6.30	14,900
RKPO - 104	101.60	18.40	47.60	11.30	28.50	28.50	38.10	6.30	4.80	11,500
RKPO - 105	152.40	30.00	50.80	14.50	36.00	36.00	38.10	6.30	6.30	14,900

## SOLID PIN CONVEYOR CHAIN A-2/K-2, K-3 ATTACHMENT

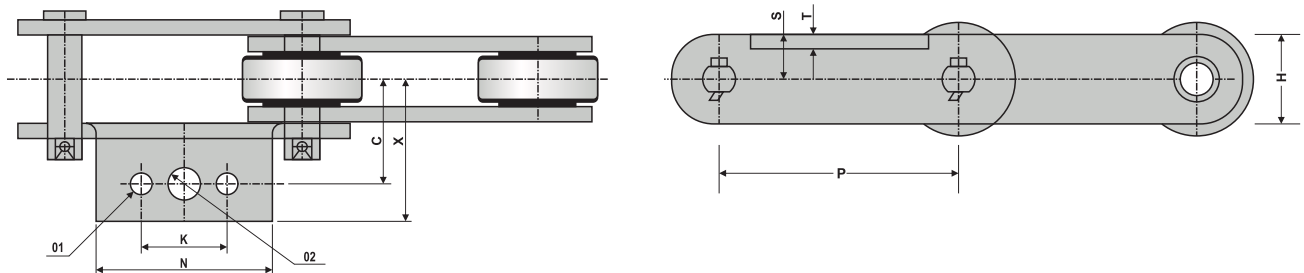

All Dimensions in MM

ROL-KOBO No.	C	X	K	N	01	02	S	T	REMARKS
RKPO - 201	44.50	62.00	31.80	63.50	10.70	13.90	15.90	4.80	A-3, K3
RKPO - 202	44.50	62.00	31.80	63.50	10.70	-	19.10	6.30	A-2, K2
RKPO - 203	44.45	61.70	31.80	71.60	10.70	13.90	31.80	6.30	A-3, K3
RKPO - 204	50.80	67.50	50.80	90.00	12.00	-	19.10	6.30	A-2, K2

## SOLID PIN CONVEYOR CHAIN (Riveted Type)

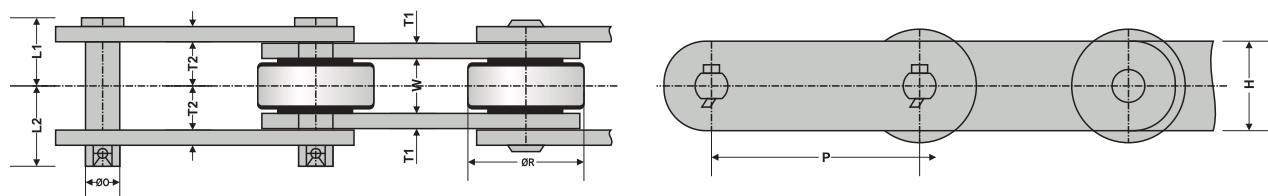

All Dimensions in MM

ROL-KOBO No.	Pitch P	Roller Diameter R	Pin Diameter D	Inner Width W	Plate Height H	Inner Plate Thickness T1	Outer Plate Thickness T2	Average Tensile Strength (ibf)
RKPO - 301	101.60	47.60	19.05	19.05	39.00	5.10	5.10	22,000
RKPO - 302	152.40	66.70	26.92	25.40	50.80	8.00	6.50	40,000
RKPO - 303	152.40	66.70	26.92	25.40	50.80	9.00	8.00	60,000
RKPO - 304	152.40	88.90	31.80	31.80	61.00	10.00	10.00	80,000



## HOLLOW PIN CONVEYOR CHAIN

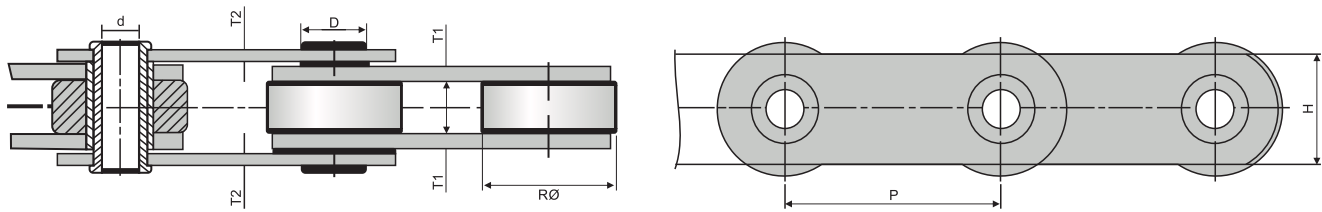

All Dimensions in MM

ROL-KOBO No.	Pitch P	Roller Diameter R	Pin Diameter D	Inner Width W	Hollow Pin d	Plate Height H	Inner Plate Thickness T1	Outer Plate Thickness T2	Average Tensile Strength (ibf)
RKPO - 401	101.60	47.60	19.05	19.05	13.21	39.00	5.10	5.10	21,000
RKPO - 402	152.40	66.70	26.92	25.40	19.56	51.00	8.00	6.50	36,000
RKPO - 403	152.40	66.70	26.92	25.40	19.56	51.00	9.00	8.00	48,000
RKPO - 404	152.40	88.90	31.80	38.10	23.10	61.00	10.00	10.00	60,000

## SOLID PIN CONVEYOR CHAIN

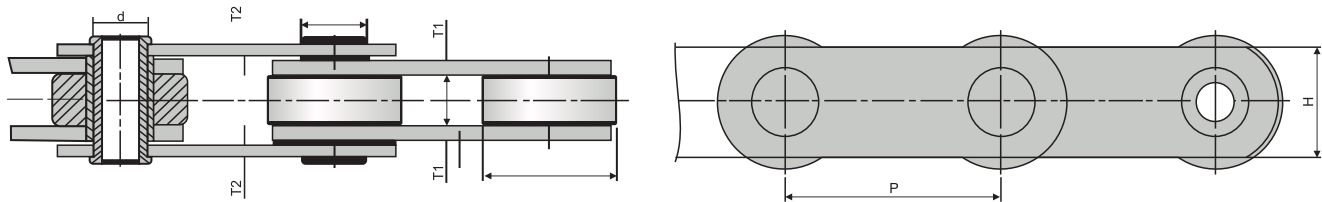

All Dimensions in MM

ROL-KOBO No.	Pitch P	Roller Diameter R	Pin Diameter D	Inner Width W	Plate Height H	Inner Plate Thickness T1	Outer Plate Thickness T2	Average Tensile Strength (lbs)
RKPO - 501	101.6	31.75	13.97	15.24	25.40	5.10	5.10	10,000
RKPO - 502	101.6	47.60	19.05	19.05	39.00	5.10	5.10	22,000
RKPO - 503	101.6	47.60	19.05	19.05	39.00	6.30	5.10	45,000
RKPO - 504	152.4	47.60	19.05	19.05	39.00	5.10	5.10	22,000
RKPO - 505	152.4	66.70	26.92	25.40	51.00	8.00	6.50	55,000
RKPO - 506	152.4	66.70	26.92	25.40	51.00	8.00	8.00	60,000
RKPO - 507	152.4	66.70	26.92	25.40	51.00	9.00	8.00	70,000
RKPO - 508	152.4	70.00	26.92	38.10	61.00	10.00	10.00	90,000

## SOLID PIN CONVEYOR CHAIN - K-1 ATTACHMENT

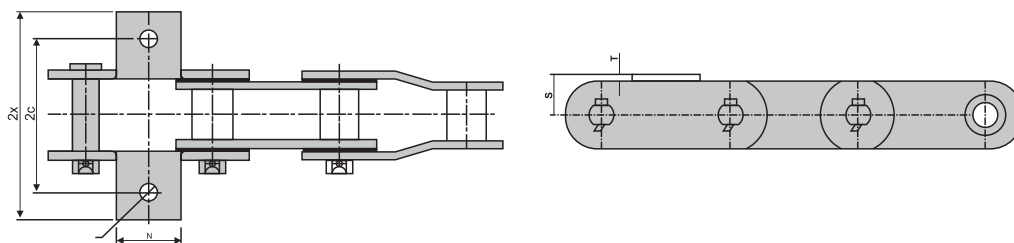

All Dimensions in MM

ROL-KOBO No.	2C	2X	N	O	S	T	REMARKS
RKPO-601	111.10	145	40	12	25.40	6.30	K1

## SOLID PIN CONVEYOR CHAIN (EXTENDED PIN)

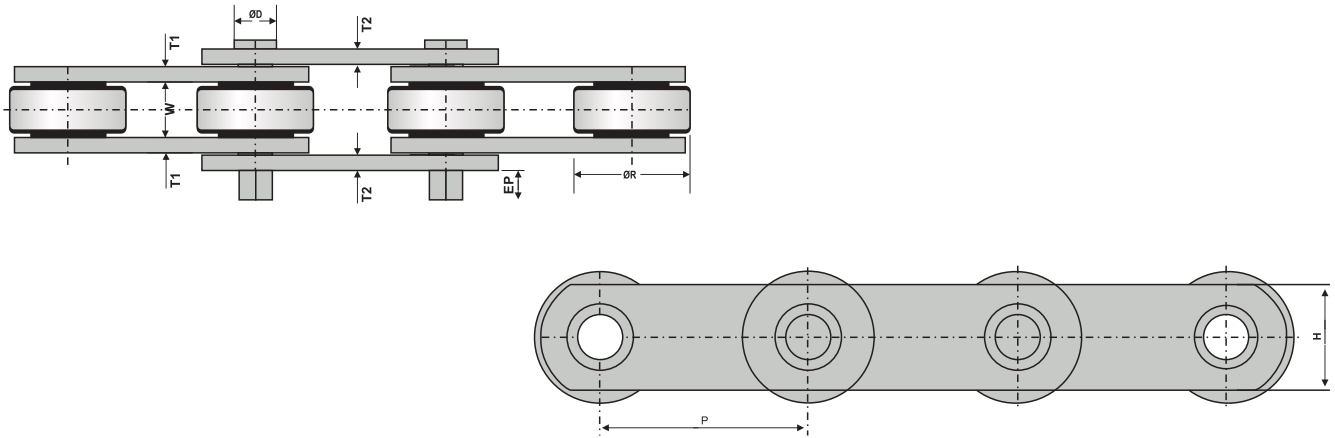

ROL-KOBO No.	Pitch P	Roller Diameter R	Pin Diameter D	Inner Width W	Plate Height H	Inner Plate Thickness T1	Outer Plate Thickness T2	Extended Pin
RKPO - 602	101.6	47.60	19.05	19.05	25.40	5.10	5.10	M16 X 40MM
RKPO - 603	101.6	47.60	19.05	19.05	25.40	6.30	5.10	M16 X 40MM
RKPO - 604	152.4	66.70	26.92	25.40	51.00	8.00	6.50	M24 X 45MM
RKPO - 605	152.4	66.70	26.92	25.40	51.00	8.00	8.00	M24 X 45MM
RKPO - 606	152.4	66.70	26.92	25.40	51.00	9.00	8.00	M24 X 45MM
RKPO - 607	152.4	70.00	26.92	38.10	61.00	10.00	10.00	M24 X 50MML

## HOLLOW PIN CONVEYOR CHAIN

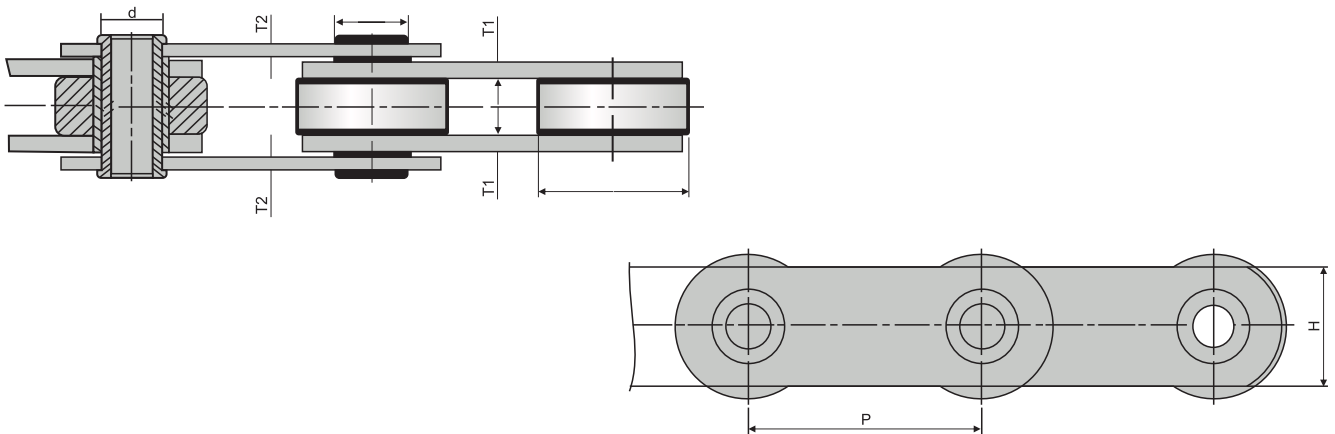

ROL-KOBO No.	Pitch P	Roller Diameter R	Pin Diameter D	Inner Width W	Hollow Pin d	Plate Height H	Inner Plate Thickness T1	Outer Plate Thickness T2	Average Tensile Strength (lbs)
RKPO - 701	101.60	47.60	19.05	19.05	13.21	39.00	5.10	5.10	21,000
RKPO - 702	152.4	66.70	26.92	25.40	19.56	51	8.00	6.50	50,000
RKPO - 703	152.4	66.70	26.92	25.40	19.56	51	8.00	8.00	60,000
RKPO - 704	152.4	66.70	26.92	25.40	19.56	51	9.00	8.00	70,000
RKPO - 705	152.4	70.00	26.92	38.10	19.56	61	10.00	10.00	90,000

## SOLID PIN CONVEYOR CHAIN

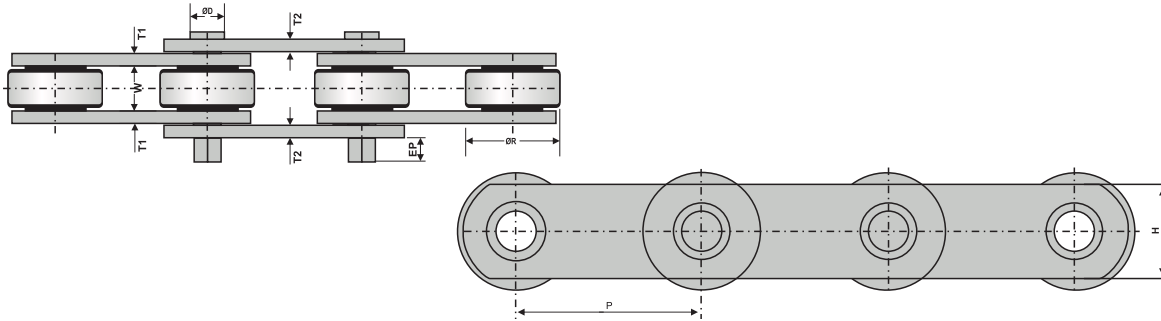

ROL-KOBO No.	Pitch P	Roller Diameter R	Pin Diameter D	Inner Width W	Plate Height H	Inner Plate Thickness T1	Outer Plate Thickness T2	Average Tensile Strength (lbs)	Extended Pin
RKPO - 801	160.00	70.00	17.50	38.00	51.00	6.50	6.50	55,000	
RKPO - 802	160.00	70.00	17.50	38.00	51.00	6.50	6.50	55,000	M16 X 50MML
RKPO - 803	152.4	70.00	19.05	38.10	51.00	9.65	9.65	85,000	
RKPO - 804	152.4	70.00	19.05	38.10	51.00	9.65	9.65	85,000	M16 X 50MML
RKPO - 805	152.4	76.20	23.88	38.10	60.00	10.40	10.40	140,000	
RKPO - 806	152.4	76.20	23.88	38.10	60.00	10.40	10.40	140,000	M20 X 60MML

## SOLID PIN CONVEYOR CHAIN

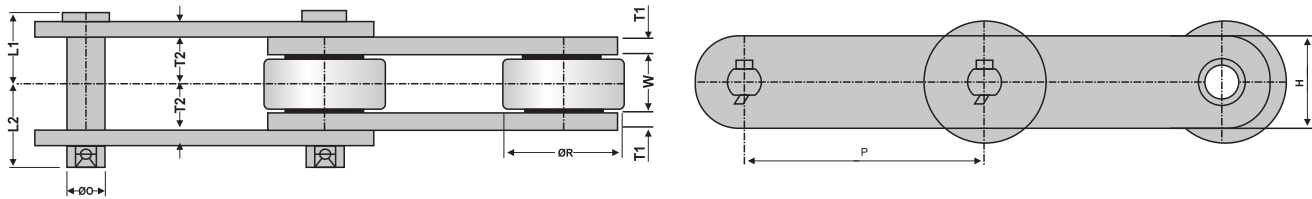

ROL-KOBO No.	Pitch P	Inner Width W	Roller Diameter R	Pin Diameter D	L1	L2	Plate Height H	Inner Plate Thickness T1	Outer Plate Thickness T2	Average Tensile Strength (lbs)
RKPO - 901	76.70	30.00	29.00	14.50	33.00	33.00	38.10	6.30	6.30	30,000
RKPO - 902	101.60	21.40	47.60	11.32	28.50	28.50	31.80	4.80	4.80	21,000
RKPO - 903	101.60	30.00	50.80	14.50	36.00	36.00	38.10	6.30	6.30	35,000
RKPO - 904	101.60	18.40	47.60	11.30	28.50	28.50	38.10	6.30	4.80	30,000
RKPO - 905	152.40	30.00	47.60	14.50	36.00	36.00	38.10	6.30	6.30	35,000

## SOLID PIN CONVEYOR CHAIN A-2/K-2, K-3 ATTACHMENT

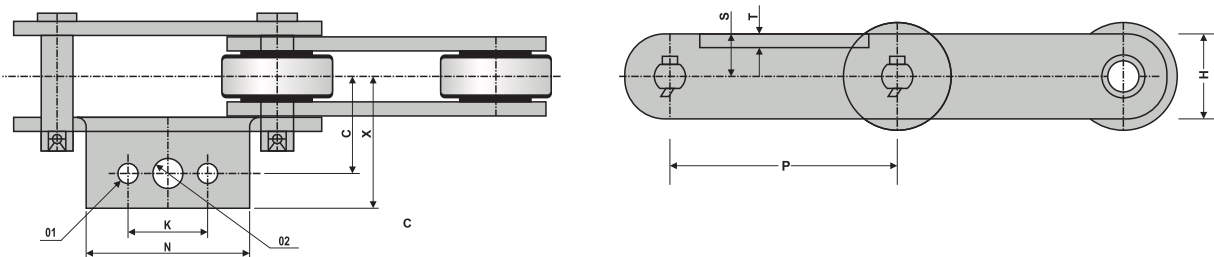

ROL-KOBO No.	C	X	K	N	01	02	S	T
RKPO - 906	44.50	62.00	31.80	63.50	10.70	13.90	15.90	4.80
RKPO - 907	44.50	62.00	31.80	63.50	10.70	-	19.10	6.30
RKPO - 908	44.45	61.70	31.80	71.60	10.70	13.90	31.80	6.30
RKPO - 909	50.80	67.50	50.80	90.00	12.00	-	19.10	6.30



Rolcon's modern Chain and Sprocket, manufacturing plants were established in 1967 in technical and financial collaboration with Messrs KOBODONGHUA GmbH & Co. KG, Germany, makers of world famous 'KOBOD' chains, having more than 105 years of experience in the field.

Rolcon being ISO 9001: 2008 certified is the largest manufacturer of Chains and Sprockets in the country. Its plant is equipped with most modern CNC machines. Special purpose machinery. New range of heat treatment machinery, and Latest testing facilities.

Rolcon's complete manufacturing range consists of Precision Industrial Transmission Chains conforming to the international standards like ISO 606/DIN 8187/DIN 8188/BS 228/ASME B29. It also manufactures, and exports Conveyor, Elevator, and Special Purpose Chains, and all suitable Sprockets for the above stated Chains.

Rolcon's Chains & Sprockets are mainly utilised in the following industries.

- Cement • Fertilizer • Steel • Sugar • Chemical • Mining • Paper Plants • Palm Oil • Food & many more industries.

Rolcon's strong network of distributors as well as sales outlets throughout India helps its esteemed customers for better communication, quick delivery, and prompt after sales service.

Rolcon's Chains are well known for its \* Highest breaking load, \* Excellent wear life, and \* Increased fatigue strength. / All the above have been achieved by selecting appropriate material, precise heat treatment, rigid quality control and constant R & D efforts done indigenously as well as from its west German collaborators.

A special marketing team of Rolcon guides, and recommends its esteemed clients for total solution for their specific requirements, and problems of chain and sprocket drives including design.

Backed by 47 years of experience in its field Rolcon has also gained lots of practical experience from its customers who are using Rolcon's chain and sprockets. This experience is continuously fed back to Rolcon's production department, which accounts for high quality standard for its products. A team of engineers and technical experts are continuously doing R&D and incorporating latest technical advances to improve the quality of chain and sprockets.



**ROLCON**  
ENGINEERING CO. LTD.  
(ISO 9001 : 2008 Company)

P. B. NO. : 20,  
Vithal Udyog Nagar - 388 121.  
Via Anand, Gujarat, India.  
Phone : (02692) 230766, 230866, 236582.  
Fax : (02692) 236453, 236480  
E-mail : [rolcon@rolconengineering.com](mailto:rolcon@rolconengineering.com)  
Web site : [www.rolconengineering.com](http://www.rolconengineering.com)